

Pool

BUILDING PERMIT APPLICATION

Ingalls, Indiana

Owner _____ Phone# _____

Address of owner _____

Contractor _____ Phone# _____

Address of contractor _____

Please fill in each of the following which apply:

- A. residential ___ B. commercial ___ C. multi family ___ D. other ___
1. new const ___ 2. addition ___ 3. remodel ___ 4. siding ___ 5. deck ___
6. pool ___ 7. demolition/removal ___ 8. access bldg ___ 9. roof ___
10. other ___

No. of bldgs ___ No. of units ___ Total sq. footage ___

Classification _____ Current Zoning _____

Location of work to be preformed _____

Lot # _____ Subdivision _____

Value of construction \$ _____

Are there any other structures on this property? Yes ___ no ___ Describe _____

Scope of work (if other than new construction) _____

I. Structural - CABO /U.B.C.

Foundation basement ___ crawl ___ slab ___ wood ___

Floor joint design brand name* _____ Spacing (C-C) _____

Ceiling joist brand name* _____ Spacing (C-C) _____

Rafters _____ Spacing (C-C) _____

Trusses brand name* _____ Spacing (C-C) _____

Laminated beam brand name* _____ Spacing (C-C) _____

Girder supports Pillars (dim): Concrete ___ Wood ___ Metal ___

Note-- Spec sheets for all manufactured trusses or any type of laminated beams or girders to be used on this construction must be submitted with permit application.

II. H.V.A.C. System – U.M.C.

Furnace type: Gas LP/Nat___ Elect___ B.T.U. ___ Efficiency___

A/C___ Type_____

Location: Garage___ Basmt___ Util rm___ Attic___ other___

Fireplace: Masonry___ Pre/fab___ Wood stove___

III. Electrical – N.E.C.

Svc panel 100 amp___ 200 amp___ other svc: det gar___ barn___

Sub panel 100 amp___ 200 amp___

Location(s)_____

Other_____

Svc Company: Pendleton Mun Elect___ P.S.I. Noblesville___ Anderson Mun___

I.V. Plumbing – B.O.C.A.

NOTE: *Indiana State law requires that all plumbers be licensed by the Indiana State Plumbing Commission* *Indiana State Plumbing Commission-1990/ I.C. 25-28.5 L.A.C. 860

Plumbing contractor_____ License #_____

Company_____

Water Heater: Gas LP/Nat___ Elect___ B.T.U. ___ Capacity___ Type_____

Bathroom(s): Number___ Showers___ Sinks___ Water Closets___

By signing below the applicant certifies and acknowledges the following:

1. I have read this application and assure the information which has been furnished and made a part of this applicant is for the purposes stated in this application and represents the entire scope of the work to be performed.
2. I understand that any mis-representation or voluntary omission made in this application may constitute revocation of this permit and may jeopardize the issuance of future permits.

Signature of owner, agent, or contractor

Date

Pools/Decks

Sample

1. a) 7 1/2 ft minimum setback required from pool structure to property lines
- b) 5 ft minimum setback for "Inman Estate"
2. Need to know how securing pool.

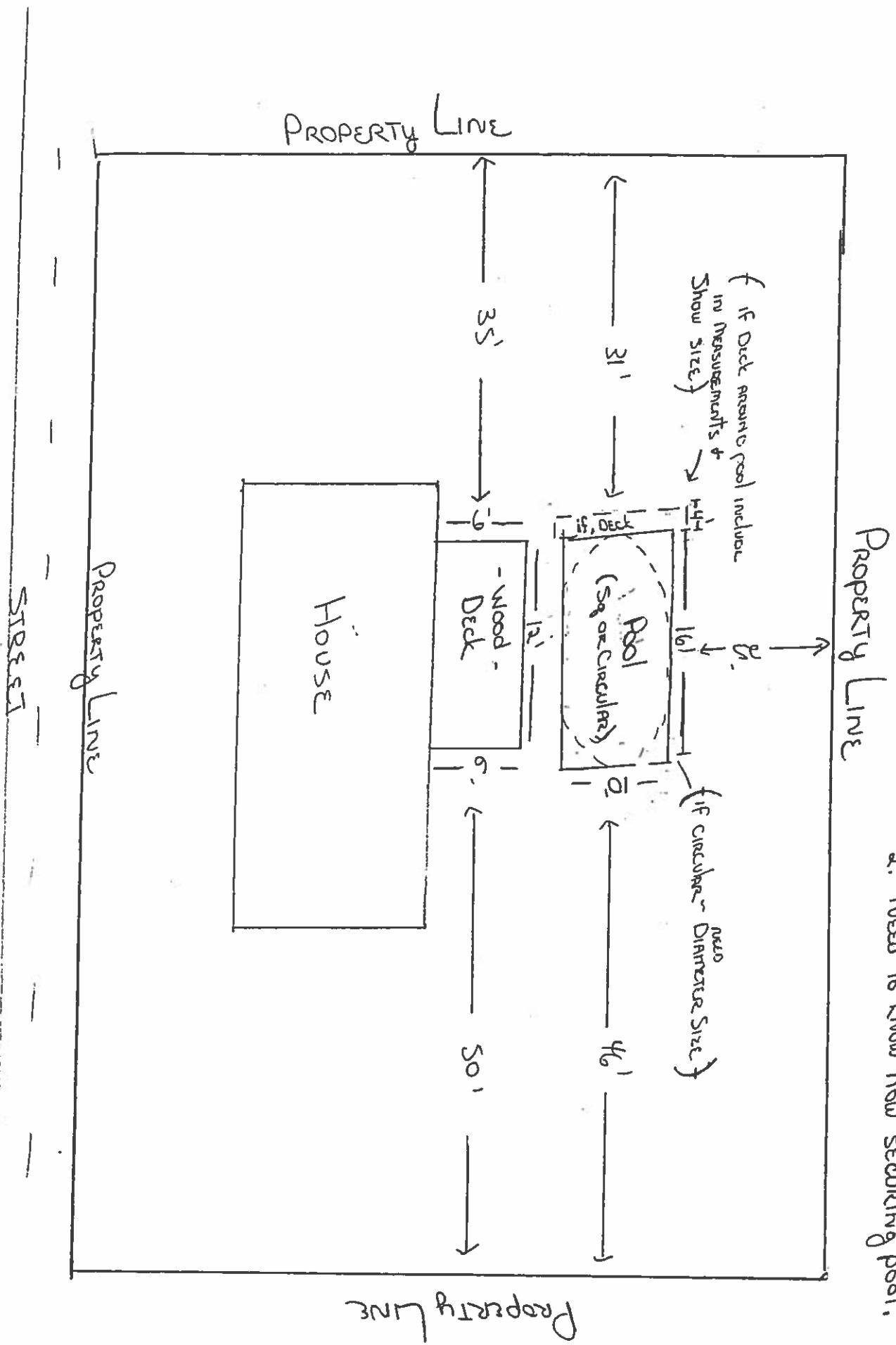

TOWN OF INGALLS

DECKS

1. **Wood or concrete?**
2. **Where located in *standing* of the house? or *setback* from house?**
3. **Dimensions of Deck?**
4. **Does a deck go around pool? If so, dimensions? Setback from property line?**

675 IAC 20-4-27 Safety features

Sec. 27 (a) A residential pool shall be provided with a suitable handhold around its perimeter in areas where depths exceed three (3) feet six (6) inches. Handholds shall be provided no further apart than four (4) feet and shall consist of any one (1) or a combination of items listed as follows:

- (1) Coping, ledge, or deck along the immediate top edge of the pool which provides a slip-resisting surface of at least four (4) inches minimum horizontal width and located at or not more than twelve (12) inches above the waterline.
- (2) Ladders, stairs, or seat ledges.
- (3) A secured rope or railing placed at or not more than twelve (12) inches above the waterline.

(b) Rope anchor devices shall be installed at a minimum of one (1) foot and a maximum of two (2) feet on the shallow end side of a point of change in floor slope. In pools where the slope change occurs in water depths less than four (4) feet six (6) inches, a transition rope supported by buoys shall be installed.

(c) Access to residential pools shall be restricted by one (1) of the following means:

- (1) Walls or fencing not less than five (5) feet high and completely surrounding the pool and deck area with the exception of self-closing and latching gates and doors, both capable of being locked.
- (2) Other means not less than five (5) feet high and deemed impenetrable by the enforcing authority at the time of construction and completely surrounding the pool and deck area when the pool is not in use.
- (3) A combination of subdivisions (1) and (2) that completely surrounds the pool and deck with the exception of self-closing and latching gates and doors which are capable of being locked. This applies to subdivisions (1) and (2) and this subdivision only.
- (4) A power safety pool cover which shall:
 - (A) provide a continuous connection between the cover and the deck, so as to prohibit access to the pool when the cover is completely drawn over the pool;
 - (B) be mechanically operated by a key or key and switch such that the cover cannot be drawn open or retracted without the use of a key.
 - (C) is installed with track, rollers, rails, guides, or other accessories necessary to accomplish clauses (A) and (B), in accordance with the manufacturer's instructions; and
 - (D) bear an identification tag indicating that the cover satisfies the requirements of ASTM F1346 for power safety pool covers.

(d) Not less than the following lifesaving equipment shall be installed with each residential swimming pool:

- (1) A ring or throwing buoy fitted with forty (40) feet of one-fourth (1/4) inch diameter line.
- (2) A pole not less than twelve (12) feet in length.
- (3) Access to a telephone.